

ICARO C

Automation for chain driven sliding gates weighing up to 1700 lb, (800 kg), gated communities and commercial buildings



Maximum safety with antisquash protection

Control panel preset for management either by means of the UNIPRO universal programmer, or built-in LCD display

Integrated high security rolling code receiver.

Auto set feature: automatically preset of working parameters.

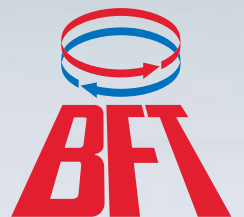

Gate automation systems
and automatic doors



ICARO C

Automation for chain driven sliding gates weighing up to 1700 lb, (800 kg), gated communities and commercial buildings

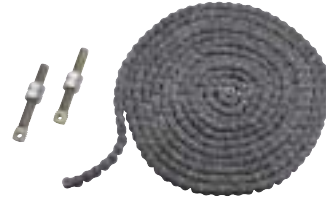
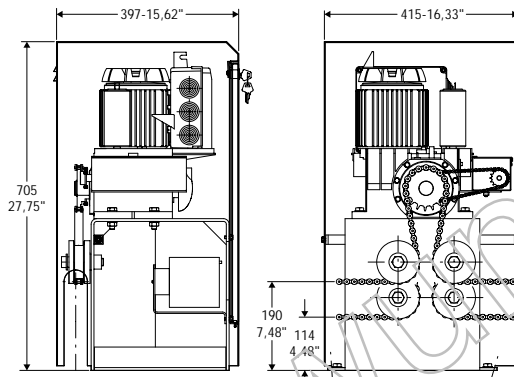
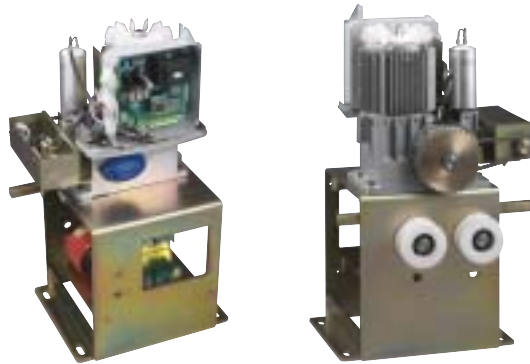

Set of 2 x 10ft # 40 chain and 2 chain bolts

Technical features

Operator ICARO C
Power supply 120 V \pm 10%, 60Hz
Power 750 W (1HP)
Thermal protection integrated
Max. gate weight 1700 lb (800 kg)
Max gate opening 40ft (12 mt)
Pinion pitch ASA 40 Z.32
Leaf speed 1 ft/sec. (18 mt/min.)
Impact reaction electronic clutch with encoder
Manual manoeuvre mechanical knob release
Control panel LEO MA
Type of limit switch electromechanical
Environmental conditions from 5°F to + 140°F (from -15°C to +60°C)
Duty cycle Continuous
Operator weight 137 lb (62 kg)
Dimensions see figure

Maximum performance and continuous service offered by ICARO C irreversible gearmotor. Parameter autosest option for braking, torque and anti-squash functions. Maximum safety with anti-squash protection, thanks to a microprocessor which guarantees innovative torque control and obstacle detection. Diagnostic and statistical functions through the display. Control board preset for management by means of the UNIPRO universal programmer. Rolling code receiver with 64 codes inside the control board.

Recommended installation

M ICARO C gearmotor with built-in control board LEO and incorporated rolling code receiver
T Rolling code transmitter
Ftx-Frx Pair of photocells FL 130
CF Pair of CF 130 photocells posts

AL LAMPO PA blinker with antenna SL433
CS Safety edge
C Chain
X Safety loop
Y Exit loop

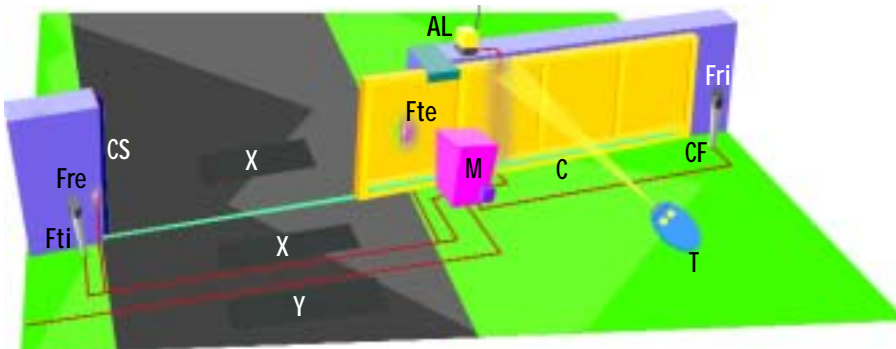

INTEGRATED CONTROL PANEL: LEO

Control panel for the management of an electromechanical single-phase actuator with a power of up to 750 W. 3 and 4 step logics with automatic or semi-automatic operation and hold-to-run control. Adjustable electrodynamic braking and torque. Rapid closing function. Partial opening input. Supports the EELINK protocol. Digital setting of parameters and logics. Visualisation of the set values on an integrated multilingual display. Autosest MENU for the automatic identification of the minimum torque requested for opening and closing, encoder sensitivity and braking. Reset menu for the original configuration set by the manufacturer (default). Self-diagnosis function. Management of statistical parameters. Management of wire connected centralised systems (master/slave system) with up to 127 zones. Adjustable partial opening. Separate open and close inputs. Separate inputs for photocell safety devices and safety edge. Clock input. 433.92 MHz built-in rolling-code receiver with 64 codes. Supplied with connector for extra BFT receiver. Extractable terminal bars for easier installation, maintenance or replacement operations.